

REGIOLUX
Made in Germany



sportler

A winner amongst luminaires

sportler

A winner for sports halls



Sports facilities make special demands on lighting systems. These demands are varied and in some ways resemble the modern pentathlon. It is reassuring to know that in the case of the sportler range, the luminaire was originally conceived with precisely this diversity in mind.

This luminaire is still in the running no matter whether different lighting technologies are required because of marked differences in mounting heights, varying installation options, excellent glare control or differing lumen outputs. Winners are not so easily beaten.



Please refer to the current data for LED luminaires under www.regiolux.de

*For information about the manufacturer's guarantee for LED luminaires, see http://www.regiolux.de/fi_leadmin/REGIOLUX/Service/Garantie/Warranty_LED_en.pdf

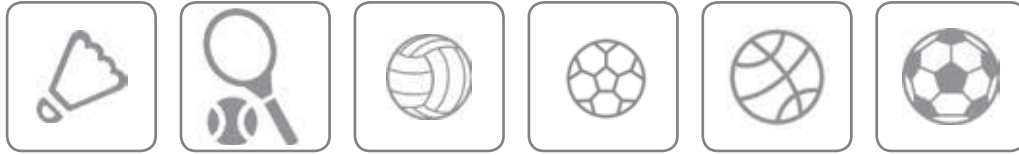

Best performance in the technical disciplines

- Very good anti-glare characteristics - UGR 19
- Efficient lighting technology with Individual.Lens.Optic
- Output levels starting at 14,700 lumen
- Suitable for ambient temperatures up to +35°C
- Can be used with mounting rails and inclined mounting

Service life

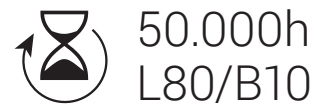

50.000h
L80/B10



Individual.Lens.Optic

SOHB

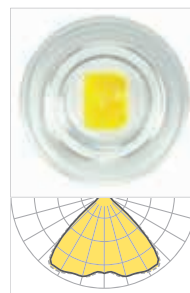

wide distribution

SOHTB

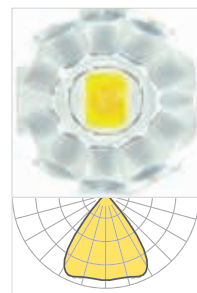

narrow/wide distribution

Efficient LED lighting for top athletic performance

Badminton hall with benefits from 50 percent energy savings

The badminton hall at the Fredericia Idrætscenter, a sports and leisure facility has been converted to energy-saving LED lighting technology. The new hall lighting not only benefits the environment, but also saves money. This is due to the obsolete 4x58 W luminaires with conventional lamps being replaced by energy-efficient high bay „sportler“ LED. The new lighting concept save approximately 6,000 W/h as the lighting solution for the 1.100 m² hall. This reduces energy consumption and electricity costs for the hall lighting by roughly 50 percent.

The old luminaires were replaced one for one during the retrofit and the „sportler“ solution was simply mounted on the existing mounting rails. 56 LED luminaires positioned along the slanted roof provide the hall with light in a manner that is both efficient as well as highly effective in providing a wide light distribution.



In the relevant working plane, i. e. on the court, they achieve a mean illuminance of 580 lx. A presence-dependent control system also ensures that lights are only turned on when needed and thereby increases savings even further. Due to the high shuttlecock strokes played during badminton matches, it was particularly important to reduce any glare. This was achieved with a UGR value of 19, making this solution ideal when it comes to top athletic performance.

The „sportler LED“ with innovative I.L.O (Individual.Lens.Optic)

application for all sports halls with ball sports: football, handball, basketball, badminton, tennis, squosch, floorball, ...





56 „sportler“ wide-angle LED luminaires provide the sports facility with a balanced and efficient lighting solution. A presence-dependent control system also ensures that lights are only turned on when needed and thereby increases savings even further.

Project data

- Construction authority**
Fredericia Idrætscenter, DK
- Lighting**
es-light aps., Fredensgade 35, DK-5000 Odense C
- Electrician**
Lindpro a/s, Brovadvej 51, DK-7000 Fredericia

Planing

SOHTB/1000 LED 22200 840
Average of Illuminance: working plane 580lx
UGR=19

Light density



Illuminance

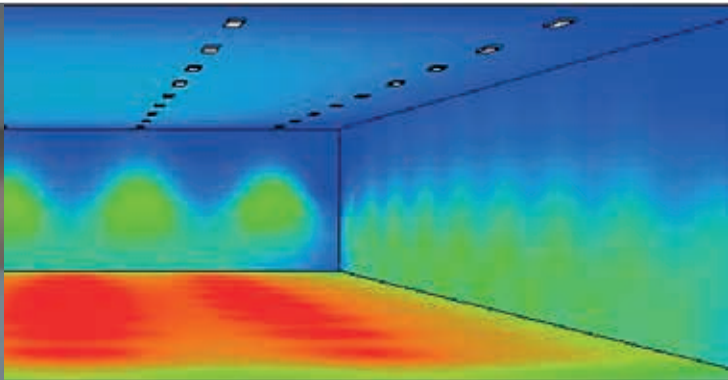

Planning a sports hall

Sports hall

In the case of an inclined roof surface an individual lighting calculation is recommended.

Mounting height MH = 7 m

Calculation basis/legend

E = Nominal illuminance

E_m = Average illuminance (hall)

$E_{m1/3}$ = Average illuminance (1/3 hall)

Utilization plane = 0,0 m

Reflection values

$\rho = 0,7$ (ceiling)/ $0,5$ (wall)/ $0,3$ (floor)

$a_1 / a_2 / a_3$ = Longitudinal spacing

b_1 / b_2 = Transverse spacing

$G_1 = E_{min} : E_m$

Lamps:

LED LF 840

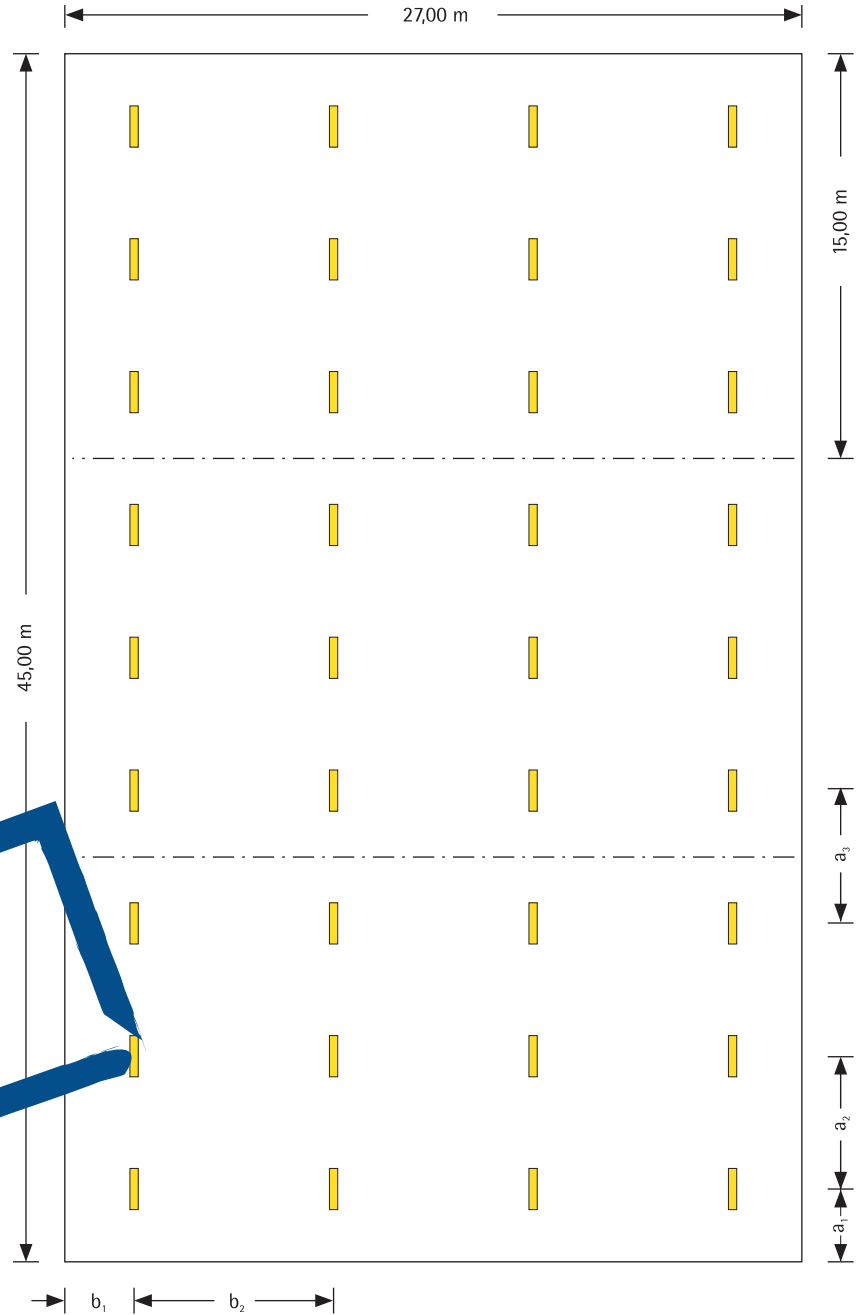
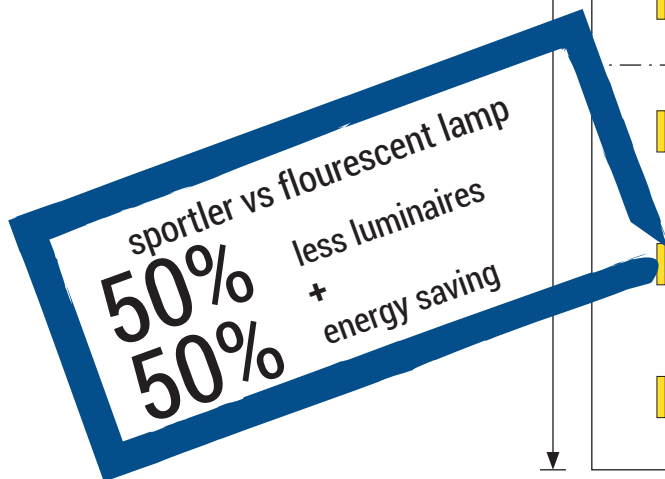

Type	lamps	E	no. of luminaires	Total power consumption (incl. ED)	a_1	a_2	a_3	b_1	b_2	G_1	E_m	$E_{m1/3}$
SOHB/700	LED 14700	300 lx	4 x 9 = 36	4,039 kW	2,50 m	5,00 m	5,00 m	2,25 m	7,50 m	1 : 1,3	370 lx	320 lx
SOHB/700	LED 14700	500 lx	4 x 12 = 48	5,386 kW	1,88 m	3,75 m	3,75 m	2,25 m	7,50 m	1 : 1,3	500 lx	420 lx
SOHB/1000	LED 22200	300 lx	4 x 6 = 24	4,042 kW	3,75 m	7,50 m	7,50 m	2,25 m	7,50 m	1 : 1,3	370 lx	330 lx
SOHB/1000	LED 22200	500 lx	4 x 9 = 36	6,062 kW	2,50 m	5,00 m	5,00 m	2,25 m	7,50 m	1 : 1,3	550 lx	480 lx
SOHB/1300	LED 29600	300 lx	3 x 6 = 18	4,041 kW	3,75 m	7,50 m	7,50 m	4,50 m	9,00 m	1 : 1,3	370 lx	330 lx
SOHB/1300	LED 29600	500 lx	4 x 6 = 24	5,388 kW	3,75 m	7,50 m	7,50 m	2,25 m	7,50 m	1 : 1,3	500 lx	430 lx
SOHTB/700	LED 14800	300 lx	4 x 9 = 36	4,039 kW	2,50 m	5,00 m	5,00 m	2,25 m	7,50 m	1 : 1,3	380 lx	340 lx
SOHTB/700	LED 14800	500 lx	4 x 12 = 48	5,386 kW	1,88 m	3,75 m	3,75 m	2,25 m	7,50 m	1 : 1,3	510 lx	460 lx
SOHTB/1000	LED 22200	300 lx	4 x 6 = 24	4,042 kW	3,75 m	7,50 m	7,50 m	2,25 m	7,50 m	1 : 1,3	390 lx	350 lx
SOHTB/1000	LED 22200	500 lx	4 x 9 = 36	6,062 kW	2,50 m	5,00 m	5,00 m	2,25 m	7,50 m	1 : 1,3	580 lx	520 lx
SOHTB/1300	LED 29600	300 lx	3 x 6 = 18	4,041 kW	3,75 m	7,50 m	7,50 m	4,50 m	9,00 m	1 : 1,3	400 lx	360 lx
SOHTB/1300	LED 29600	500 lx	4 x 6 = 24	5,388 kW	3,75 m	7,50 m	7,50 m	2,25 m	7,50 m	1 : 1,3	520 lx	470 lx



Mounting:

- Suspended
- Ceiling surface

Housing:

- Sheet steel housing, powder-coated

Lighting technology SOHB:

- Individual.Lens.Optic; PMMA plastic
- Lighting characteristic direct wide distribution

Lighting technology SOHTB:

- Individual.Lens.Optic; PMMA plastic
- Lighting characteristic direct narrow/wide distribution

Lamp:

- LED
- CRI ≥ 80 / 4000K

Switching:

- Various switching modes available
- The number of control units varies according to the version
- Electronic driver
- 230V 50Hz

Miscellaneous:

- Electrical connection via connection cable 2,3 m

Accessories:

- Protection and mounting accessories are to be ordered separately

sportler-SOHB/700 LED

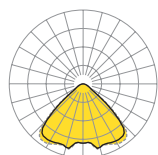

SOHB/0700 IP40 LED
14700 lm 840

η_{LB} 100%
lm/W 131
direct/indirect 100/0%
UGR lat./long. 22,0/22,2

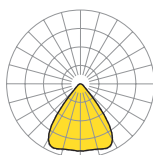

SOHTB/1000 IP40
LED 22200 lm 840

η_{LB} 100%
lm/W 132
direct/indirect 100/0%
UGR lat./long. 19,0/19,1

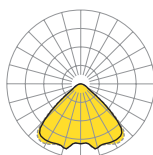

SOHB/1300 IP40 LED
29600 lm 840

η_{LB} 100%
lm/W 132
direct/indirect 100/0%
UGR lat./long. 22,0/22,2

Dimensions

Type	Versions	LxBxH/DxH	A1	A4	KE X/Y
SOH./0700	LED	688 x 340 x 59	655	235	261 / 0
SOH./1000	LED	1013 x 340 x 59	980	235	423,5 / 0
SOH./1300	LED	1338 x 340 x 59	1305	235	586 / 0

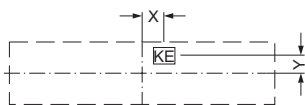

Surface mounting

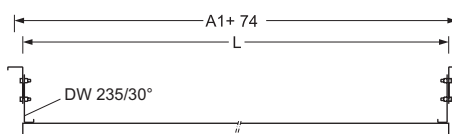
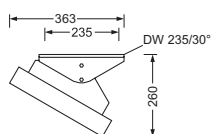
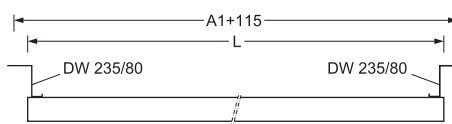
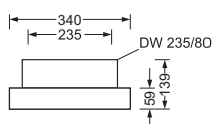

Suspended mounting

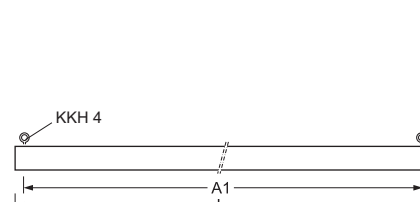
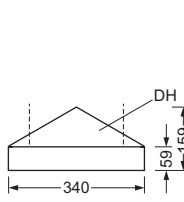
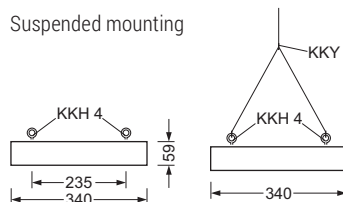

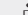

Products

Type	Lamps	P _{sys} [W]	Colour	Ballast	LxBxH/DxH	Item number	
Individual.Lens.Optic direct wide distribution							
sportler-SOHB/0700 IP40	LED 14700lm 840	112	vw	ED	688 x 340 x 59	3743 0124 110	6,40
				DALI	688 x 340 x 59	3743 0126 610	6,40
sportler-SOHB/1000 IP40	LED 22200lm 840	168	vw	ED	1013 x 340 x 59	3743 0224 110	9,00
				DALI	1013 x 340 x 59	3743 0226 610	9,00
sportler-SOHB/1300 IP40	LED 29600lm 840	224	vw	ED	1338 x 340 x 59	3743 0324 110	11,40
				DALI	1338 x 340 x 59	3743 0326 610	11,40
Individual.Lens.Optic direct narrow/wide distribution							
sportler-SOHTB/0700 IP40	LED 14800lm 840	112	vw	ED	688 x 340 x 59	3743 0124 130	6,40
				DALI	688 x 340 x 59	3743 0126 630	6,40
sportler-SOHTB/1000 IP40	LED 22200lm 840	168	vw	ED	1013 x 340 x 59	3743 0224 130	9,00
				DALI	1013 x 340 x 59	3743 0226 630	9,00
sportler-SOHTB/1300 IP40	LED 29600lm 840	224	vw	ED	1338 x 340 x 59	3743 0324 130	11,40
				DALI	1338 x 340 x 59	3743 0326 630	11,40

Accessories

	Type	Colour	Material	Details	Item number	kg
<i>Protection</i>						
Roof hood	DH /0700	vw	St	for sportler, worker	3729 0700 100	1 1,50
	DH /1000	vw	St	for sportler, worker	3729 1000 100	1 2,20
	DH /1300	vw	St	for sportler, worker	3729 1300 100	1 2,80
<i>Mounting</i>						
Chain suspension	KK	me	St	Chain l=30m, for SDT, SDT Basic, ATS, suspended luminaires	9282 9300 100	1 4,60
	KKH 4	me	St	Chain carabiner suspension kit for worker, sportler, hara	3729 0004 100	4 0,11
	KKY 2	me	St	Chain carabiner set for Y suspension	3729 0005 100	2 0,03
Mounting-ceiling	DW 235/80	vw	St	Ceiling brackets fix for sportler, worker, hara	3729 0001 100	2 1,00
	DW 235/30°	vw	St	Ceiling brackets variable for sportler	3729 0006 100	2 1,62

Mounting note sportler

Surface mounting

DW 235/80

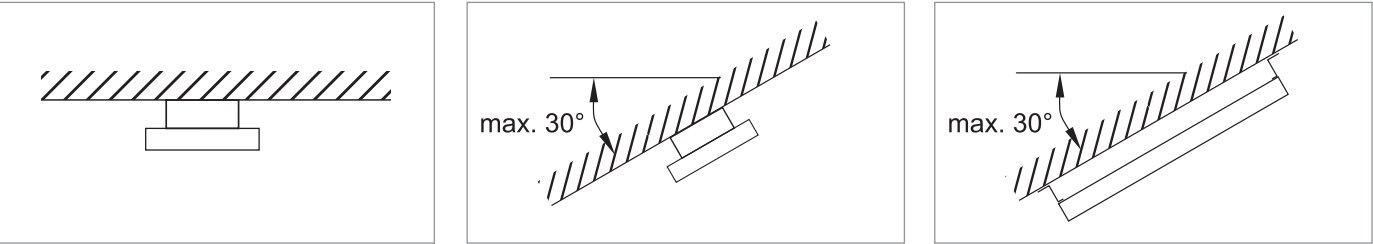

DW 235/30°

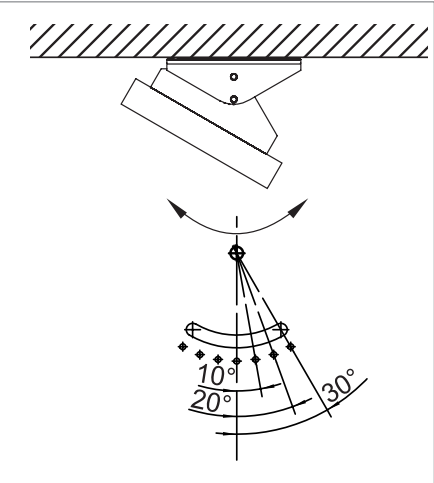
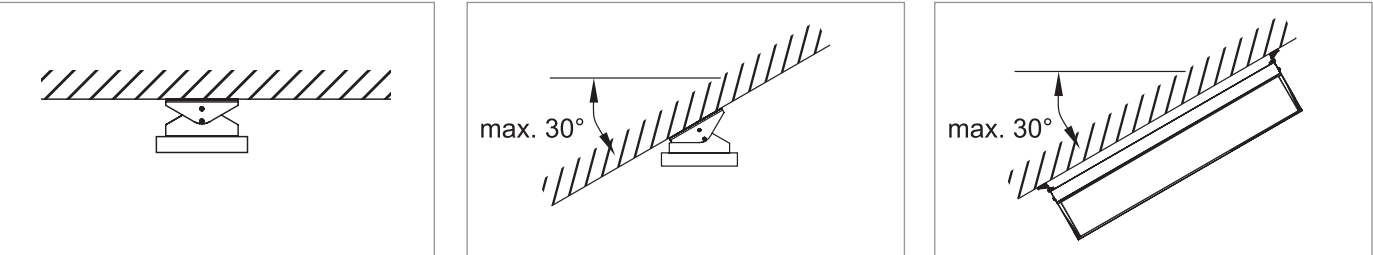

Suspended mounting

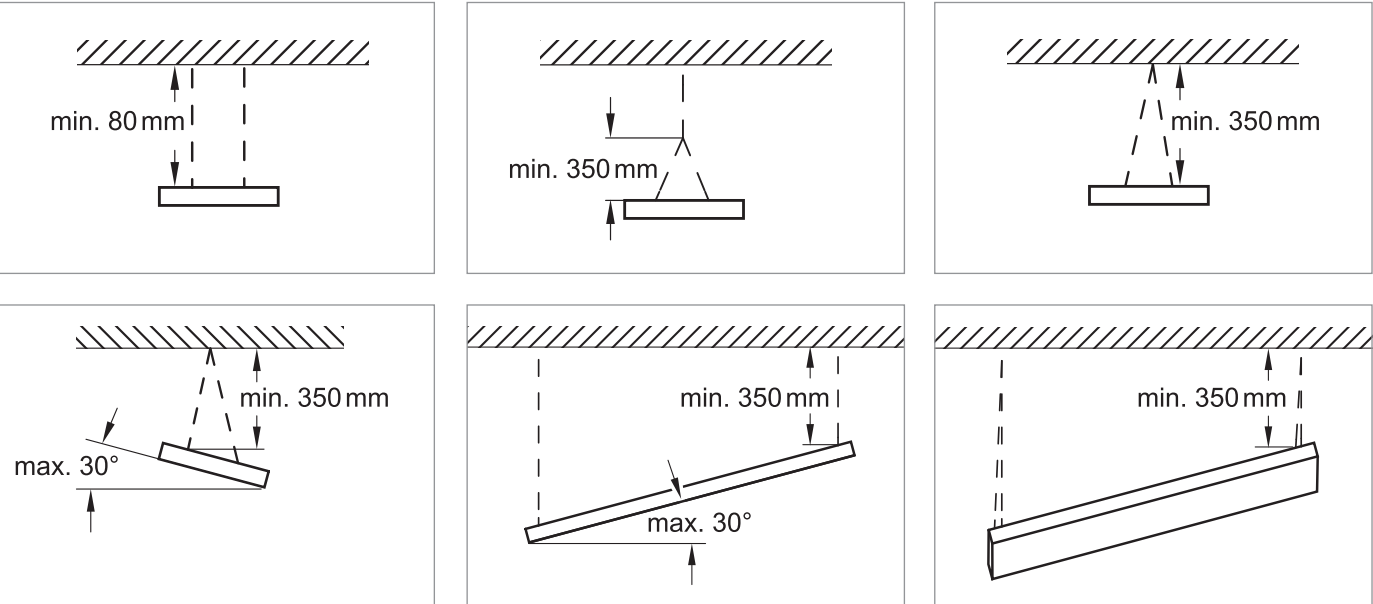

Accessories for mounting rail installation

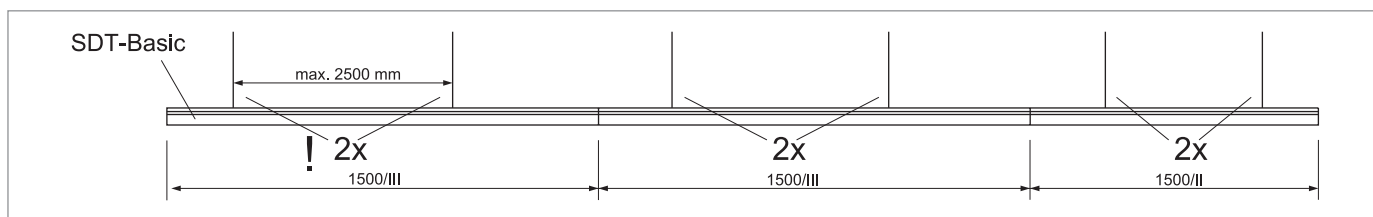
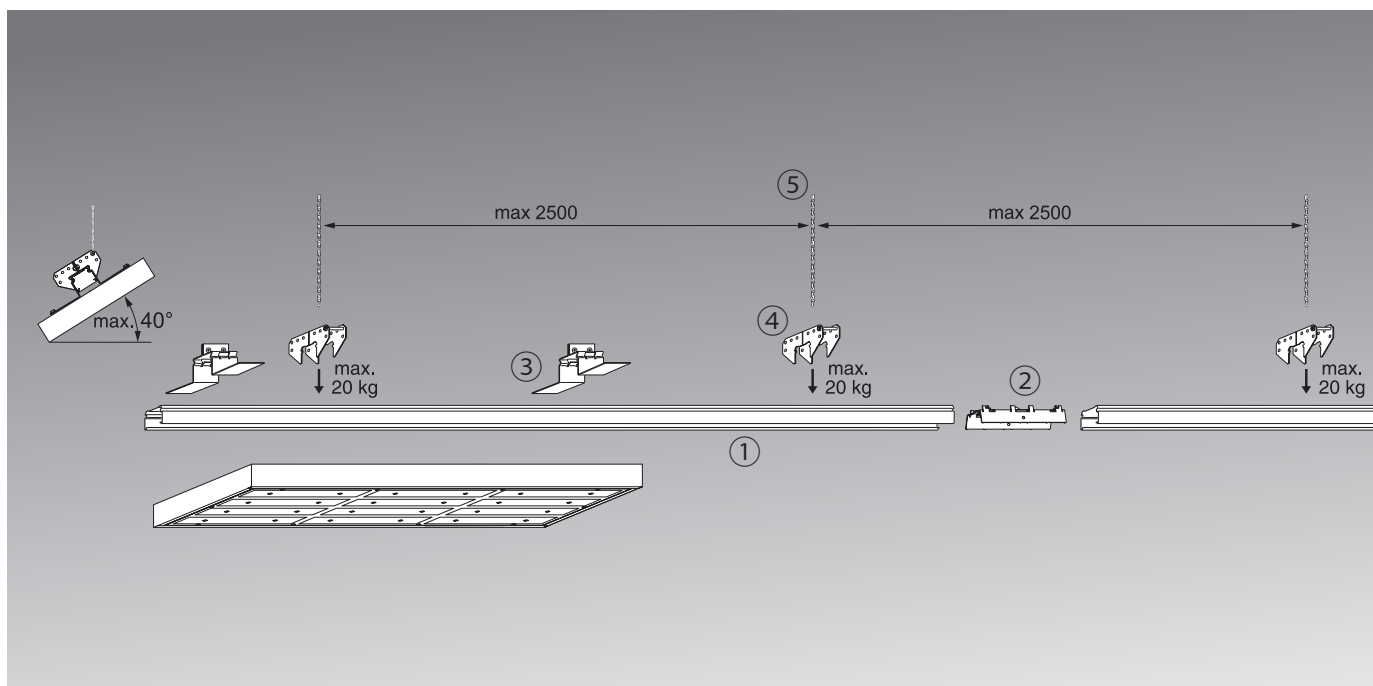

- ① SDT basic unwired mounting rail
- ② SDTV mounting rail connector
- ③ Luminaire fixing BW-SDT
- ④ Angle hanger SDT-WA
- ⑤ Suspension (chain) KK

Accessories

	Type	Colour	Material	Details	Item number		
<i>Design</i>							
Section cover	SDBAV 1500	vw	St	l=7x219=1533mm for SDT Basic	1884 5580 101	1	0,88
<i>Mounting</i>							
Chain suspension	KK	me	St	Chain l=30m, for SDT, SDT Basic, ATS, suspended luminaires	9282 9300 100	1	4,60
	SDT -WA	me	St	for SDT Basic	6820 9300 120	1	0,25
<i>Structure</i>							
Luminaires fixing	BW-SDT	vw	St	SDT mounting set for sportler, worker	3729 0009 100	2	0,88
Mounting rail	SDT Basic 1500/II	vw	St.galv.	l=3070mm 2.6kg for surface-mounted luminaires	1825 2580 150	1	2,60
	SDT Basic 1500/III	vw	St.galv.	l=4605mm 3.9kg for surface-mounted luminaires	1825 3580 150	1	3,90
Mounting rail connector	SDTV	me	St.galv.	for SDT	1820 0020 100	1	0,22



Sport hall luminaires



quanta

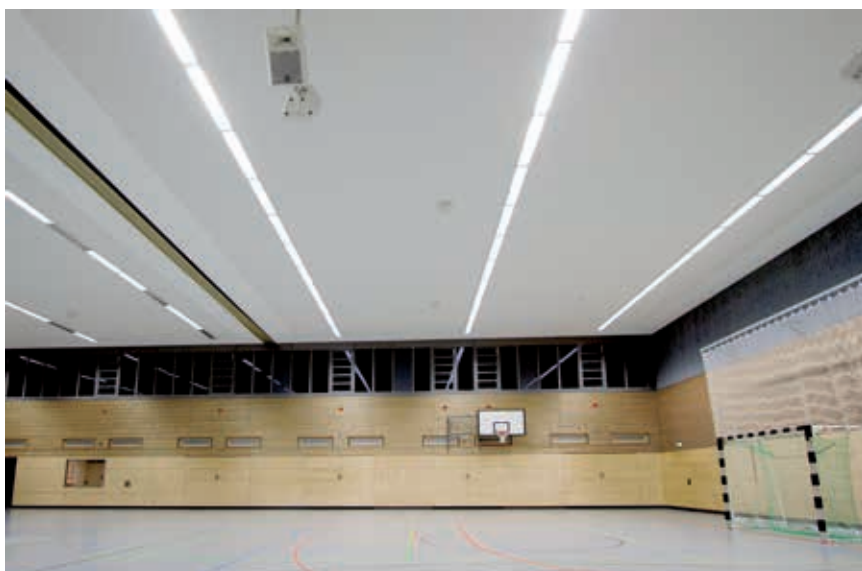

THL. LED



Photo index

Page	2	nednapa · shutterstock
	4,5,7	Jake Campbell, Kiel DE · Fredericia Idrætscenter, Fredericia DK
	8	Andrey Kiselev · Fotolia
	12	Boris Golz, Arnsberg DE · IGS - Integrierte Gesamtschule, Nienburg, DE
	12	Robert Endres Regiolux GmbH DE · Sporthalle Bergtheim, Bergtheim, DE



Regiolux



REGIOLUX
Made in Germany

Regiolux GmbH
Hellinger Straße 3
D 97486 Königsberg
T +49 9525 89 0
F +49 9525 89 7
info@regiolux.de
www.regiolux.de